

## CASE STUDY

# CCL

CAST CONTRACTING  
LIMITED

# Latitude Housing Development, Pylands Lane

A dual waterproofing solution was required for a collection of semi-detached houses on a new housing development in Bursledon



## THE CHALLENGE

Latitude is a new housing development from Bellway Homes set in the small village of Bursledon, near to the River Hamble. The contemporary development comprises a collection of high specification apartments and 2, 3, 4 and 5 bedroom houses.

Waterproofing Specialists Cast Contracting Ltd (CCL) were commissioned by John Reilly Civil Engineering Ltd, to install an RIW

dual waterproofing system into a series of new semi-detached houses at the site.

The houses, built on a sloping area of the site, were to be constructed with an earth retaining wall on three sides. The residential development needed to be waterproofed to a Grade 3 habitable environment in accordance with BS 8102:2009 (Protection of below ground structures against water from the ground).



## THE SOLUTION

To form the 'Type A' waterproofing system required, CCL installed RIW's Structureseal Pre-applied Sodium Bentonite membrane under the concrete slabs, with RIW Liquid Asphaltic Compound (LAC) spray applied coating to the concrete retaining walls.

RIW Double Drain was installed to protect the membrane during backfilling operations and to help the drainage of water to the maintainable land drain.

CCL installed RIW Sealing Compound around pile heads, and RIW Sheetseal 226 self-adhesive membrane to the transition between Structureseal and LAC, as reinforcement to the wall/floor junctions.

The second and final form of defence was achieved with the installation of a 'Type C' fully maintainable water management system to the internal face of the structure.

This included the installation of RIW's R7 Cavity Drain membrane to the concrete retaining walls and R20 Cavity Drain membrane to the concrete slab fitted above an extruded polystyrene insulation layer.

CCL incorporated the installation of RIW's Aquachannel perimeter drain which connected to gravity drainage outlets positioned at the non-retaining side of the property. To allow for maintenance of the system, inspection ports were fitted within the channel.



## PRODUCTS

RIW Structureseal

RIW LAC

RIW Double Drain

RIW R7 & R20 Cavity Drain

RIW Aquachannel

75mm extruded polystyrene insulation

RIW Sheetseal 226

Cast Contracting Ltd

01256 763100 info@ccl-ltd.net www.ccl-waterproofing.co.uk

Lodge Farm Hook Road North Warnborough Hook Hampshire RG29 1HA

PEACE OF MIND  
GUARANTEED

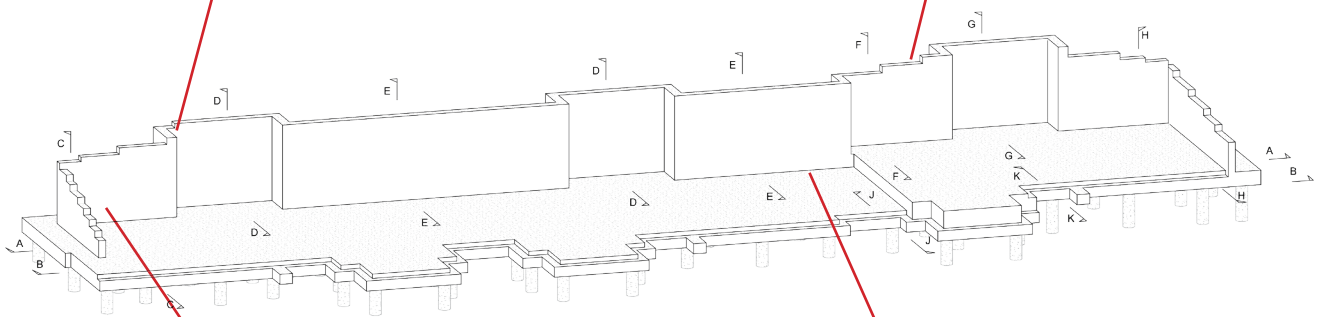

#### CLIENT TESTIMONIAL:

*“The specialist waterproofing team from CCL worked closely with main contractor Bellway Homes and John Reilly Civil Engineering Ltd to install the most effective waterproofing solution for the project. Their attendance at regular design meetings ensured the correct sequencing and strict installation deadlines were achieved onsite.”*

**Matt Robbins**, Quantity Surveyor, John Reilly Civil Engineering Limited